

SA-34-2

Spring 1973

Fatio House



STENOGRAPHER  
**NOTEBOOK**

29¢

BOOK NO.

FROM

Deagan

50 SHEETS • SIZE 6 IN. x 9 IN. • GREGG RULED

No. 205807

Made exclusively for McCrory Corporation, York, PA. 17402

1.

Kitchen Bulbry -  
extends S to artillery lane  
on all 18<sup>th</sup> at maps

1893 - Kitchen building ends before  
the main building begins - has  
porch w shingle roof on the back  
1917 - shingle roofed porch only on South  
 $\frac{1}{2}$  of back kitchen

Puerto Rico Map - This site is # 243 Block V  
26 Naves north; 46 Naves E east

May 16 1973

at Ximenez Fatio House

SA-34-2 Full crew

setting Transit station on cement  
in walkway at SW corner of  
present Kitchen building.

will Tie all points into NW corner  
of Fatio House E-W section, and the  
SW corner of Kitchen building

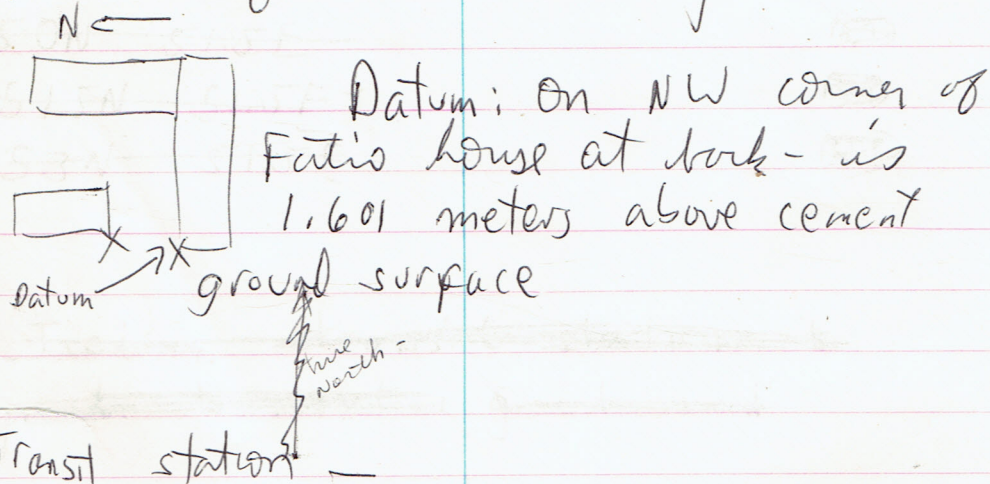

1<sup>st</sup> stake SON SDF - is  $17^{\circ}20''$

West of North  $\hat{=}$  5.77 meters from  
Transit station



stake 50 N 51.5 E is  $16^{\circ} 15'$   
W of N, 1.5 meters from stake  
50 N 50 E

the E-W stake line set in  $180^{\circ}$  W of  
stake 50 N 51.5 E - 2 meter intervals  
stake elevations

<del>50 N 50 E -</del>	<del>50 N 51.5 E</del>	
<del>51.5 N 50 E -</del>	<del>51.5 N 50 E</del>	<del>BD</del>
<del>53 N 50 E -</del>	<del>53 N 50 E</del>	<del>BD</del>
<del>50 N 51.5 E -</del>		<del>BD</del>
<del>51.5 N 51.5 E -</del>		<del>BD</del>
<del>53 N 51.5 E -</del>		<del>BD</del>

~~Tied in transit station to~~  
~~grid. transit grid and~~

permanent transit station is  
2.66 m from NW corner of Fatio  
house. datum pt. is 1.62 m. from  
surface and NW corner datum pt is  
 $31^{\circ}$  E of true N-S.

# Stakes 4.

50N 50E 1.68 BD ~~1.80~~  
 50N 48.5E 1.72 BD ~~1.80~~  
 50N 47.0E 1.73 BD ~~1.80~~  
 50N 45.5E 1.75 BD ~~1.80~~

~~48.5~~  
~~1.8~~  
 47.0

~~47.0~~  
~~1.8~~  
~~48.5~~  
 47.0

~~22,500~~

51.5N 45.5E 1.75 BD  
 51.5N 47E ~~1.73~~ BD  
 51.5N 48.5E 1.72 BD  
 50.5N 50E 1.74 BD

have removed rd - & leveled immediate  
 area underneath -

levels: 50N 50E 1.75

51.5N 45.5E - 1.85

51.5N 50E - 1.77

50N 48.5E - 1.85

will begin excavating this entire 4.5 x 1.5  
 unit by 15 cm levels

irregular

at 1.76 bd a bright layer of crushed  
 coquina is apparent - this disappears  
 within 1 cm, under which is shell filled  
 humic soil

.35

All measurements from  
Trans. Station



$\angle$   
 $\angle$  E of N

Old Kitchen, NW corner: 10.87m at 349.20

Trench A

50N 50.9E - 5.54m at 351.75°  $\approx$  352°

51.5N 50.9E - 6.98m at 350.25°  $\approx$  350°

~~50N 50.9E -~~

~~51.5N 50.9E -~~

50N 45.5E - 7.21m at 363.65°  $\approx$  304°

51.5N 45.5E - 8.44m at 310.25°  $\approx$  310°

SW corner of Fatio House - 160° at 727m

Photographs, color & B&W, taken of  
Feature 1 in Trench A.

Map made - compass map of all features  
on lot made in transit

Feature I - at ca 1.74 below a layer  
of mortar over coquina rubble appears  
(10 cm below ground surface) extends as  
a footing west of kitchen building  
foundation, then ends. At the ending  
point, a water pipe can be discerned just  
below the surface - may have disturbed  
foundation / floor. West of this point  
is a zone of hard packed earth and

shell, coquina etc - 1.80 - possibly  
a floor area - This extends the  
length of the trench except for  
a small area in the SW corner.

See map

floor cut & profiled between  
stakes SON 50.9E & SON 50E  
at 2.04 bd - some small blocks

Level 1 0-15 cm dred  
SON 50E - 1.79 SON 45.5E - 1.81  
S1.5N 50E - 1.81 S1.5N 45.5E - 1.87

at base of this zone a <sup>small</sup> coquina-mortar  
area appears at 1.84 bd Mapped

Zone 2 - work is going extremely  
slowly w/ 1 hand screen - we  
now screening only south  $\frac{1}{2}$  of  
trench - maintaining same levels -  
6"

profile from 50W 50E —

second floor level appears in profile - does not extend into kitchen wall, although this may be the result of a building trench for the present kitchen building.

The area mapped in just E of stake 50W 48E of coquina & rubble bottom out at —

(coquina area - closed at 1.88)

This may well have been part of the western extension of the floor revealed at 1.79 - probably was part of 19<sup>th</sup> century porch - tramps printed pebbles & red brick found in this coquina area

Have abandoned screening until next floor level is reached - at 2.01

between stakes 50W 48.5E and 50W 50E light brown soil appears in a distinct

line at 2.0 bd - may be pipe trench  
or may be upper level of old  
grade level sloping downwards from  
East to West

Level

~~Zone II~~ closed 15-30 cm (presumably)

50N 50E - 1.98

51.5N 50E - 1.98

50N 45SE - 2.05

51.5N 45SE - 2.04

FS 2

Level 3 begun - we have not  
excavated the area East of 51.5N,  
49.95E; 50N 49.95E became a  
floor or capping. Have opened a small  
test pit in SE corner of trench  
see map

~~April~~ May - 18 Cumbon gone,  
fences & large here  
mapping Feature 3 at 2.04 bd  
a black soil, trench-like area  
extending SW-NE across trench, with  
a square column block at E side  
and possible P.H. at N end

is at ca. 51.5N 48.5E, 50N 48.5E  
seared out - material seared - may  
be footing trench for porch?

in SE Test pit - at 2.21 6d  
3 probable potholes appear extending  
EW - from wall of kitchen building  
mapped - most westerly accidentally  
removed before it could be mapped  
was in line

Fea 2 cloud - is deeper in N end -  
2.39 - in south end 2.22

FS 3

in SE Test pit at 2.

Level 3 cloud

51.5N 50E - 2.11

50N 45.5E - 2.14

50N 50E - 2.11

51.5N 45.5E 2.14

FS 4

2.51 blank  
2.37 shell

at the W edge of what was, floor  
2. a fragment area of coquina  
is apparent at 2.01 5d

Closing Level 4.1 bag at FS 5

50N 50E - 2.26<sup>BD</sup>

51.5N 50E - 2.28

50N 45.5E - 2.31

51.5N 45.5E - 2.30<sup>BD</sup>

Closing level 5 2 Bags AT FS 6

N. E.			N. W.	
<del>51.5N 50E</del>	2.41	BD	2.48	BP.
S. E.	2.41	BD	S. W.	2.49 BD.

small pit in SE corner of Trench A mapped  
contained oyster shells; San Marcos  
(see map)

at this level - several features  
appear

Fea 3 - at sterile level  
the Trench is sterile except  
for an area of tan mottled soil  
in S part of □ against bulk -  
this is a very large pit - Top 2.55 -  
have excavated this in the West

end to 125 cm below ground  
surface without reaching sterile -  
St. Johns & San Marcos Ceramics  
present at this trench - seems to  
be from an earlier Indian occupation  
• have decided not to attempt  
to reach bottom because of  
lack of time - Spanish occupation  
level seems to end with black  
midden zone

Are profiling S, E and W walls of  
Trench A.